

LRX-294 Series

The strong ring lights (direct) developed by EMAC Ltd. are suitable for general use with the machine vision systems. The light use special LEDs with small beam angle 30°x60°. We recommend using with separate LED illumination controller mentioned in the paragraph Accessories. Operating temperature is from +10°C to 55°C.



Order codes and technical parameters

Order code	LED colour	Luminous flux Φ_v [lm]	Power P_n [W]	Voltage U_n [V] DC	Current I_n [A] DC	Weight m [kg]
LRW-294	White	662	16,1	12	1,34	0,5
LRR-294	Red	314	16,1	12	1,34	0,5
LRB-294	Blue	180	16,1	12	1,34	0,5

Accessories

Order code	Description
HRX-294	Set of 2 pcs holder, 6 pcs screws (4x M5x10, 2x M6x10), 2 pcs T-nuts 10/M6 3842530285 (Rexroth Bosch)
CA-D2	Extension cable 2m (KEYENCE)
CA-D5	Extension cable 5m (KEYENCE)
CA-DC100	LED Illumination controller (KEYENCE)
CA-U4	Power supply 24VDC 6A (KEYENCE)

Spot light intensity distribution (typical)

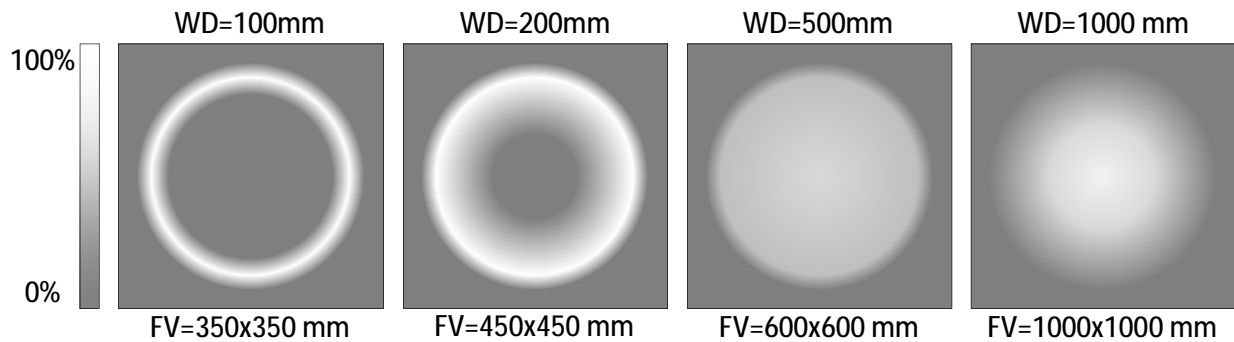

Dimensions of LRX-294 [mm]

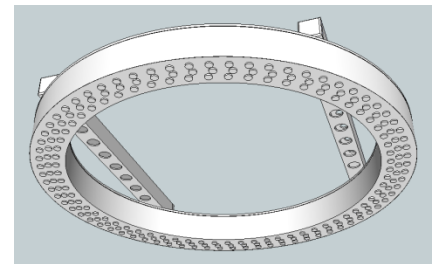
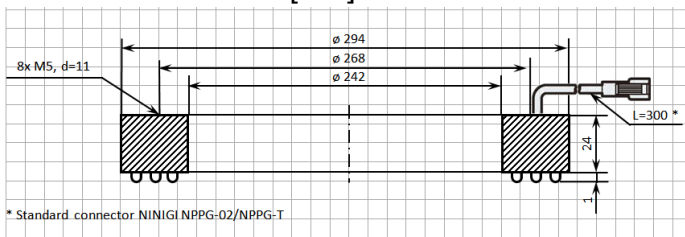

Dimensions of holders HRX-294 [mm]

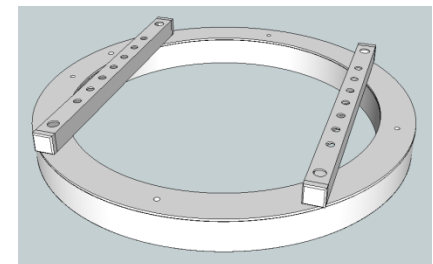
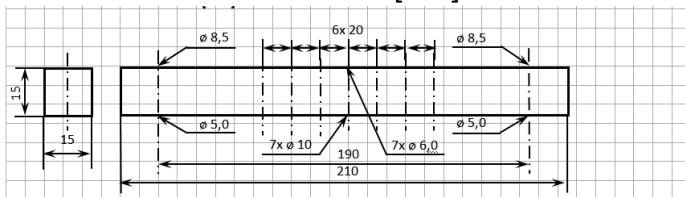

Notes: All specifications correct at time of publishing. In the interests of continual improvement, EMAC Ltd. reserves the right of alter specifications without notice.